

SCHILLER

2017 S1-C User Manual



Schiller was founded on the daring belief that a blue planet is meant for biking. We want to give people of all athletic abilities the most exhilarating and dynamic cycling experience riding the world's most advanced water bike.

Our commitment to design, technology, safety and engineering, matched with a passion for all things aquatic, is what guides us each and every day.

On behalf of the entire Schiller Bike's team, I want to personally thank you for your purchase and congratulate you on pioneering a new era of water biking. I hope you enjoy the thrill of cycling across the water as much as we do at Schiller Bikes.

Bike a blue Planet!

A handwritten signature in black ink, appearing to read 'Judah', with a large, stylized initial 'J' and a horizontal line extending to the right.

Judah Schiller
Founder & CEO

1. Getting to Know Your S1	2
2. Box Contents	3
3. Assembly	4-14
Protective caps	4
Handle Bars	5
Left Pedal	6
Right Pedal	7
Outdrive	8-10
Struts	11-12
Pontoon inflation	13
Running Boards	14
4. General Guidelines	15-19
Seat height adjustment	15
Outdrive pivot adjustment	16
Outdrive use positions	17
General best practices	18-19
6. Maintenance	20
7. Warranty & Support	21

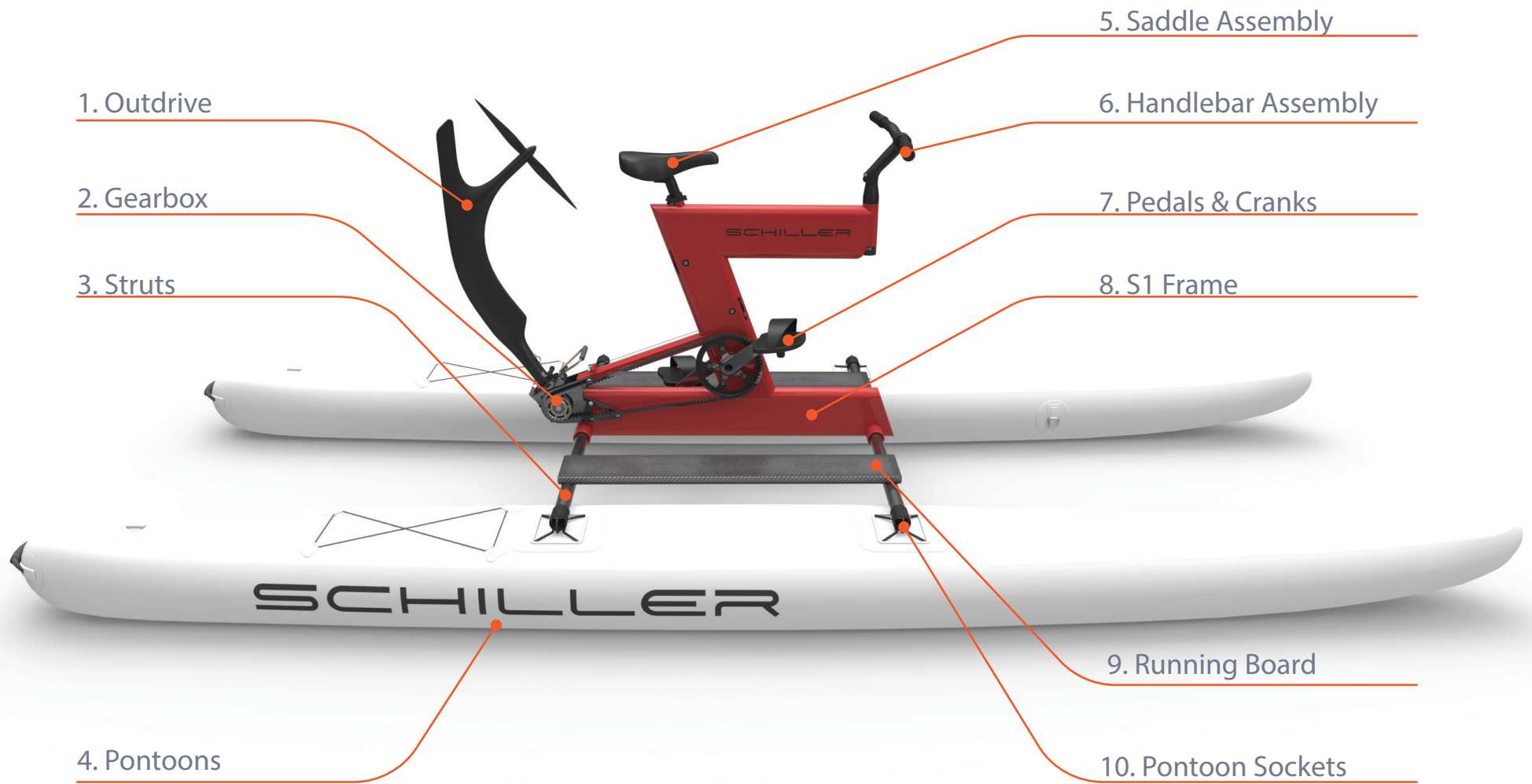

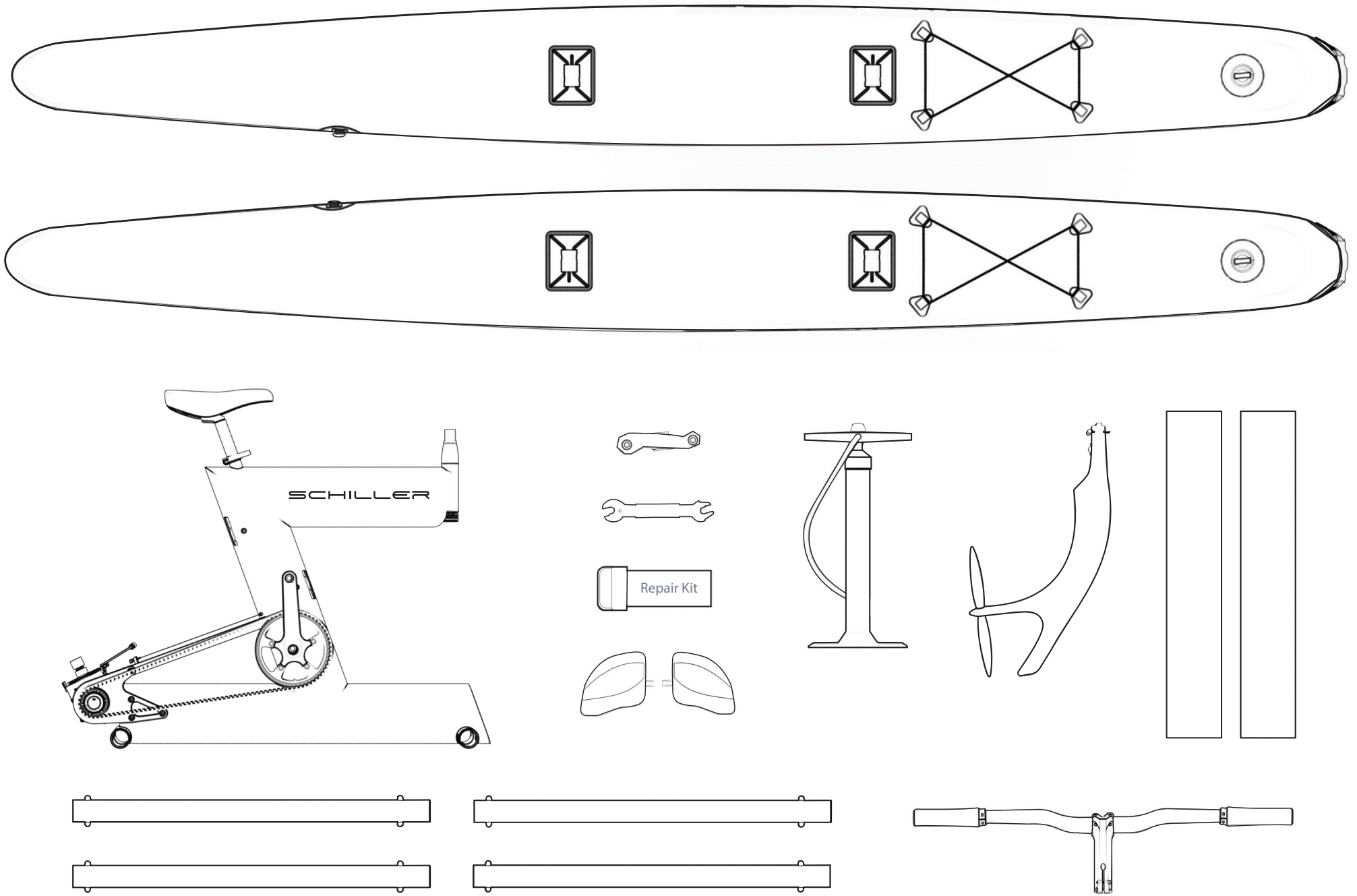

Remove protective caps.

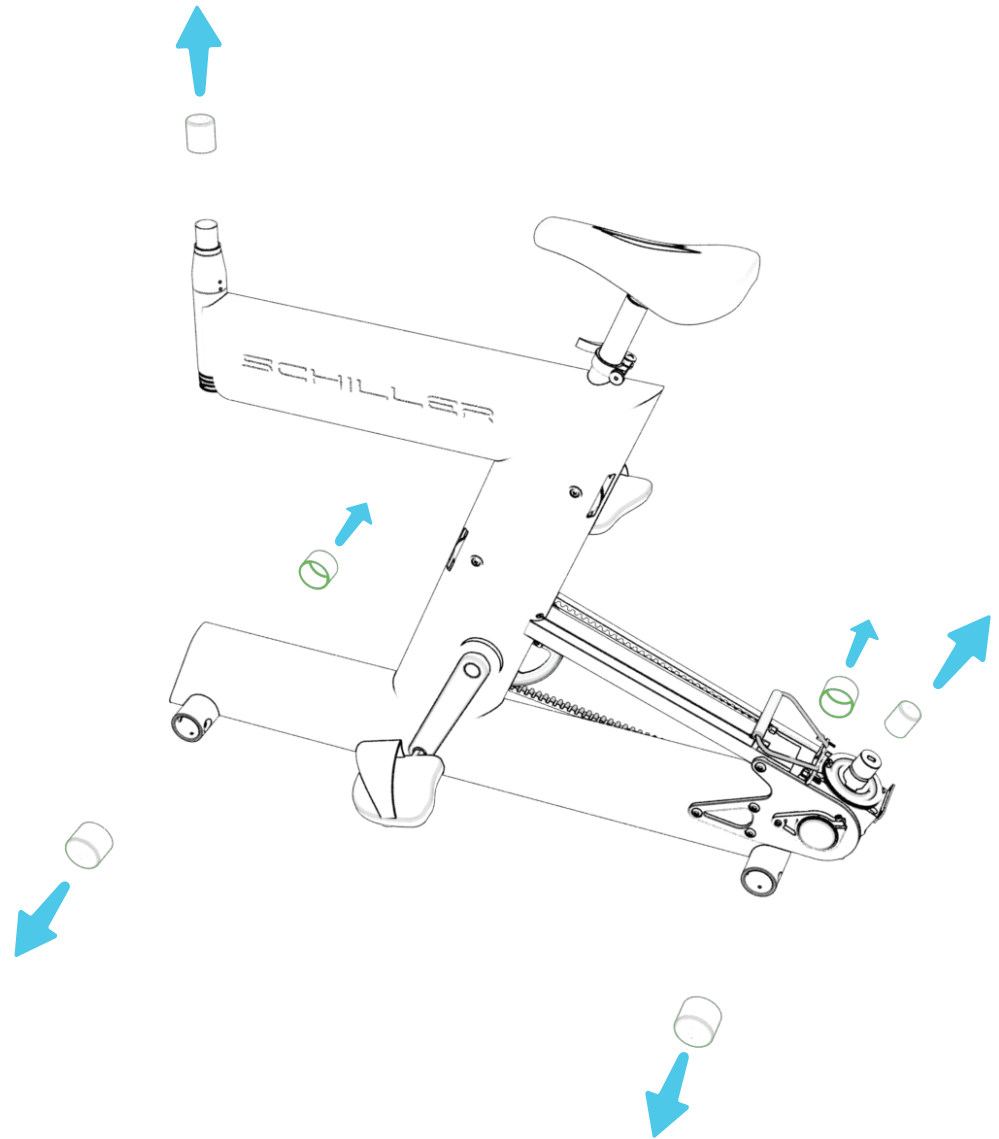
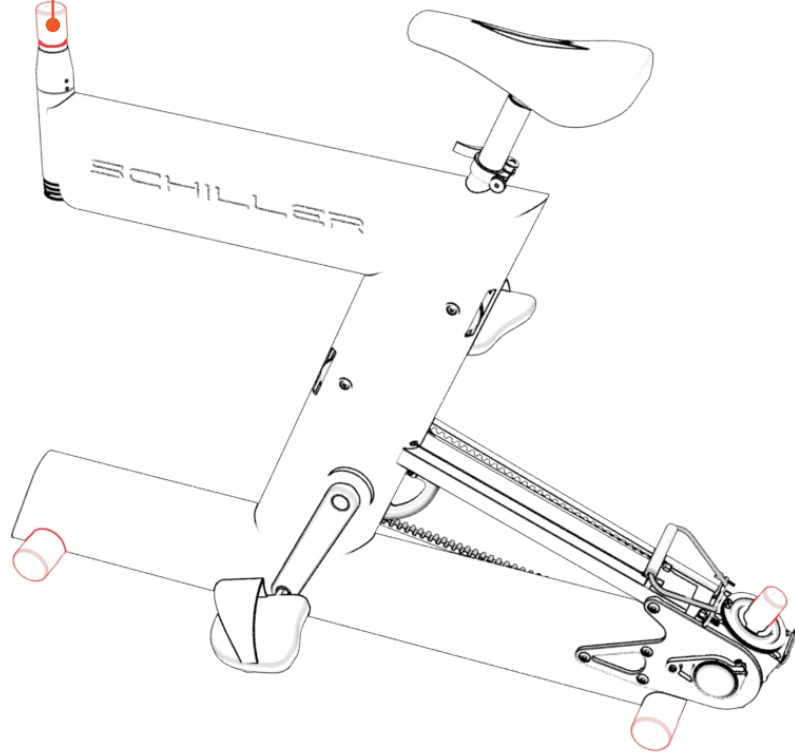

1

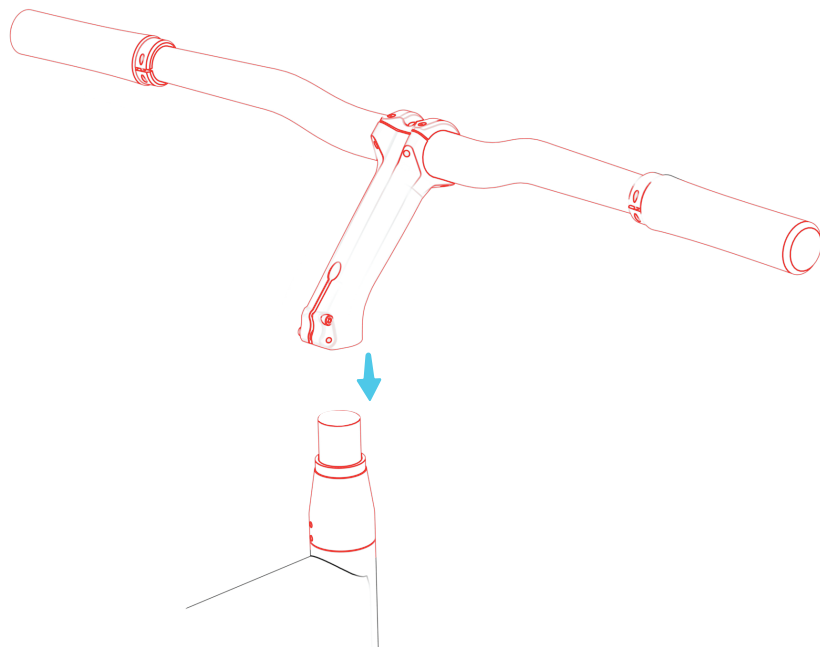

2

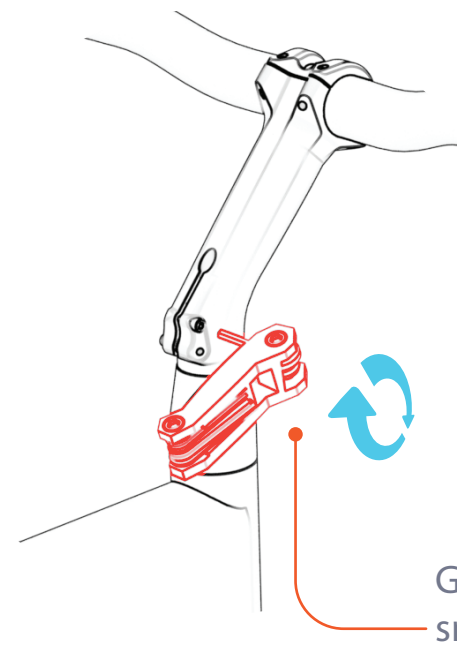

Gently tighten until snug.

3

Repeat step 3 until snug.

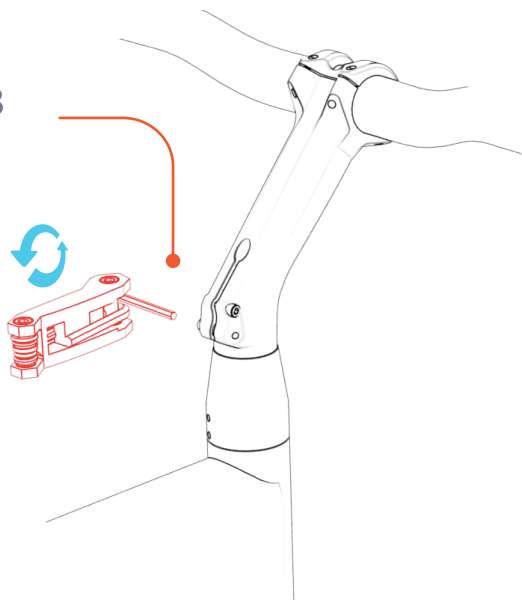

4

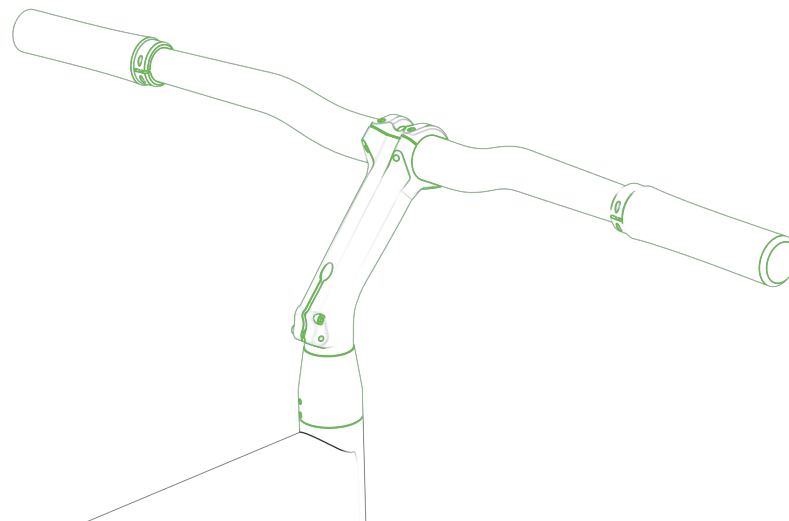

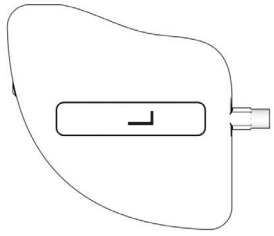

Note which pedal by finding the letter on the bottom. Remove rubber band, or protective cap from threads

1

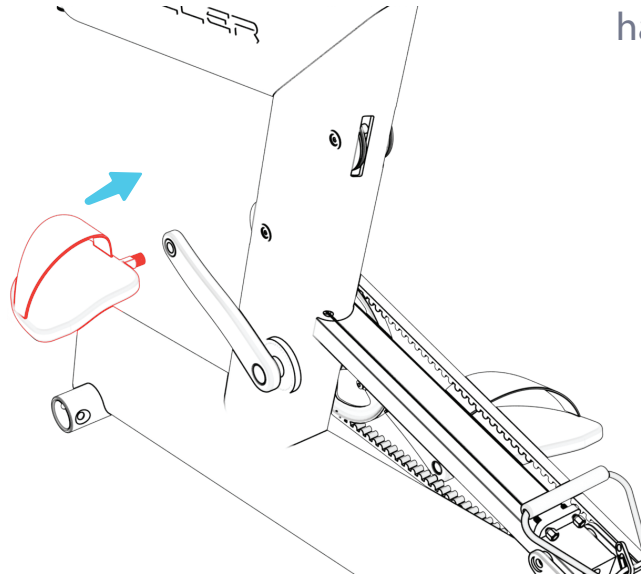

Tighten by hand first.

2

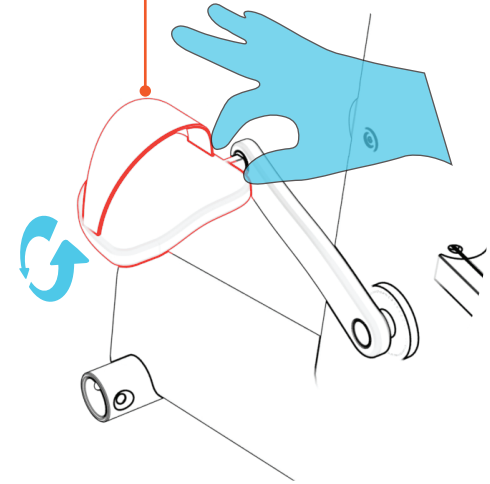

3

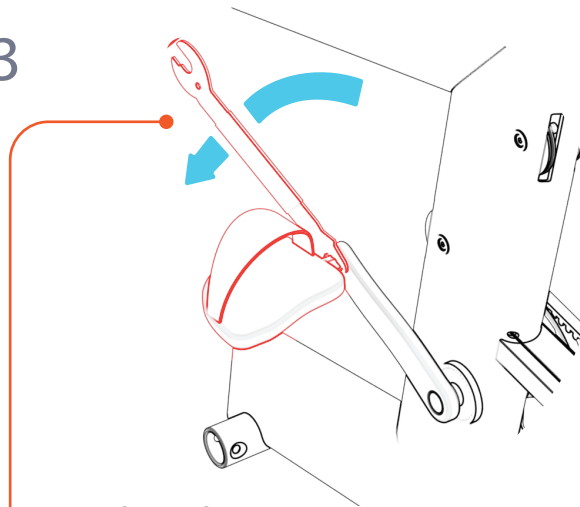

Gently tighten Pedel with wrench until snug.

4

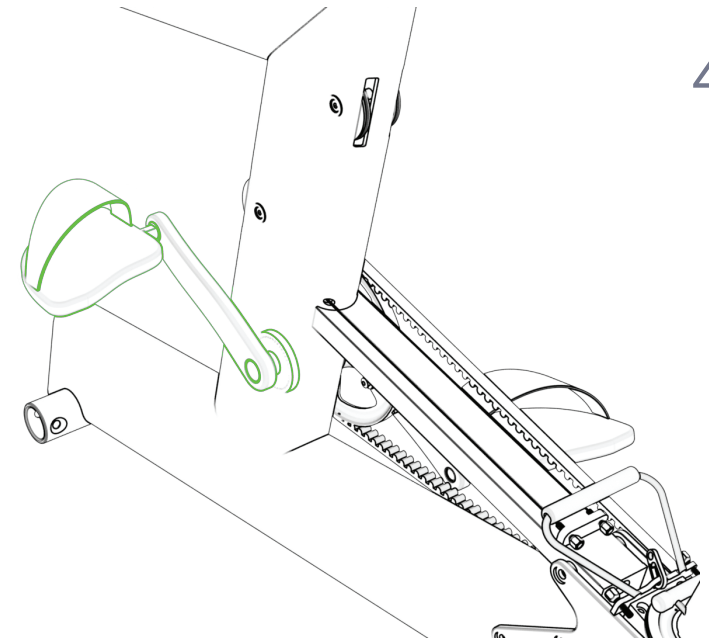

1

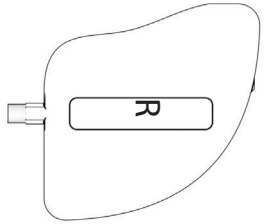

Note which pedal by finding the letter on the bottom. Remove rubber band, or protective cap from threads

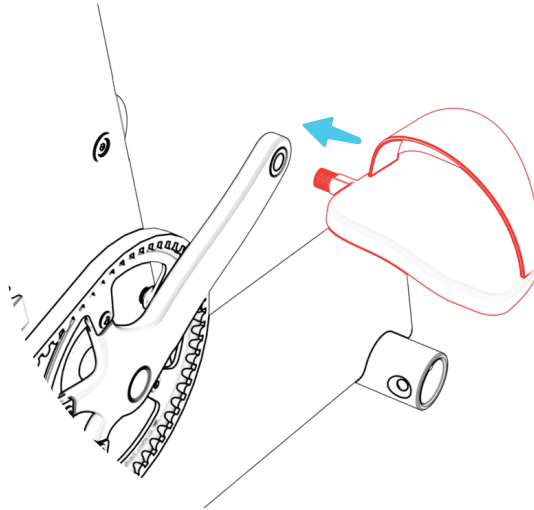

2

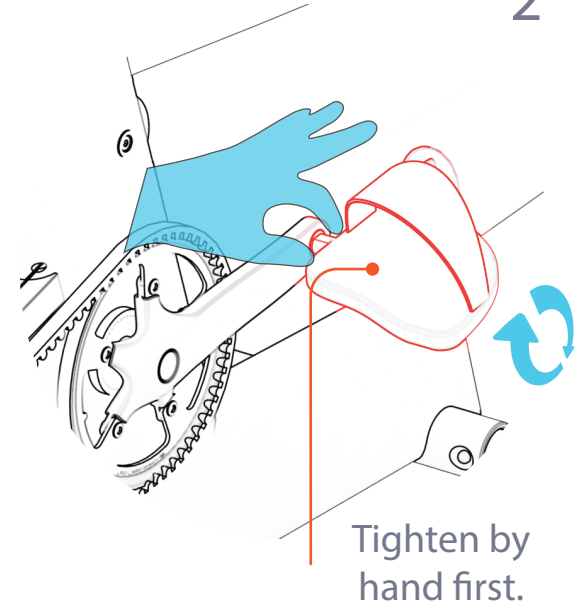

3

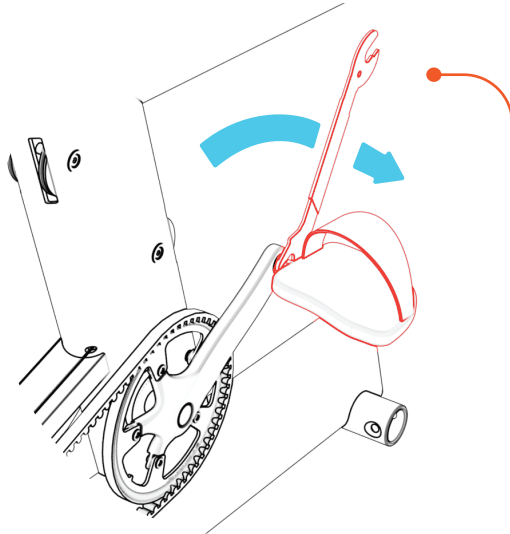

Gently tighten Pedal with wrench until snug.

4

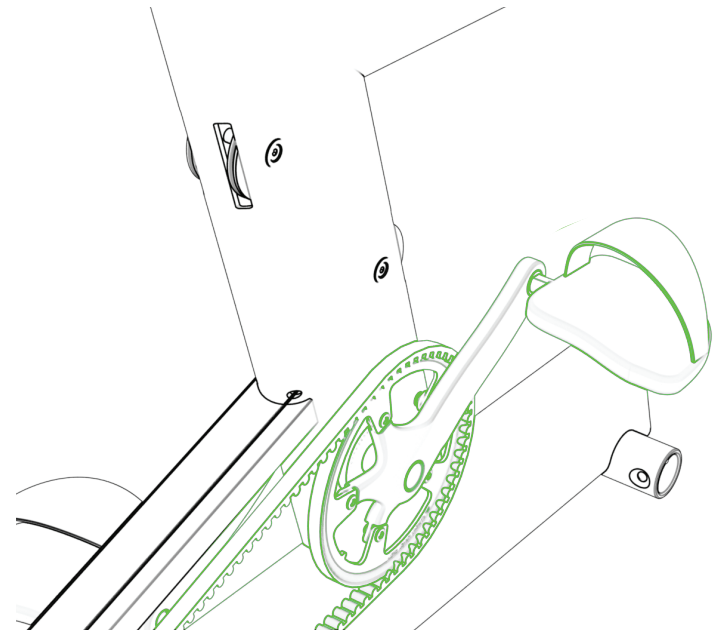

1

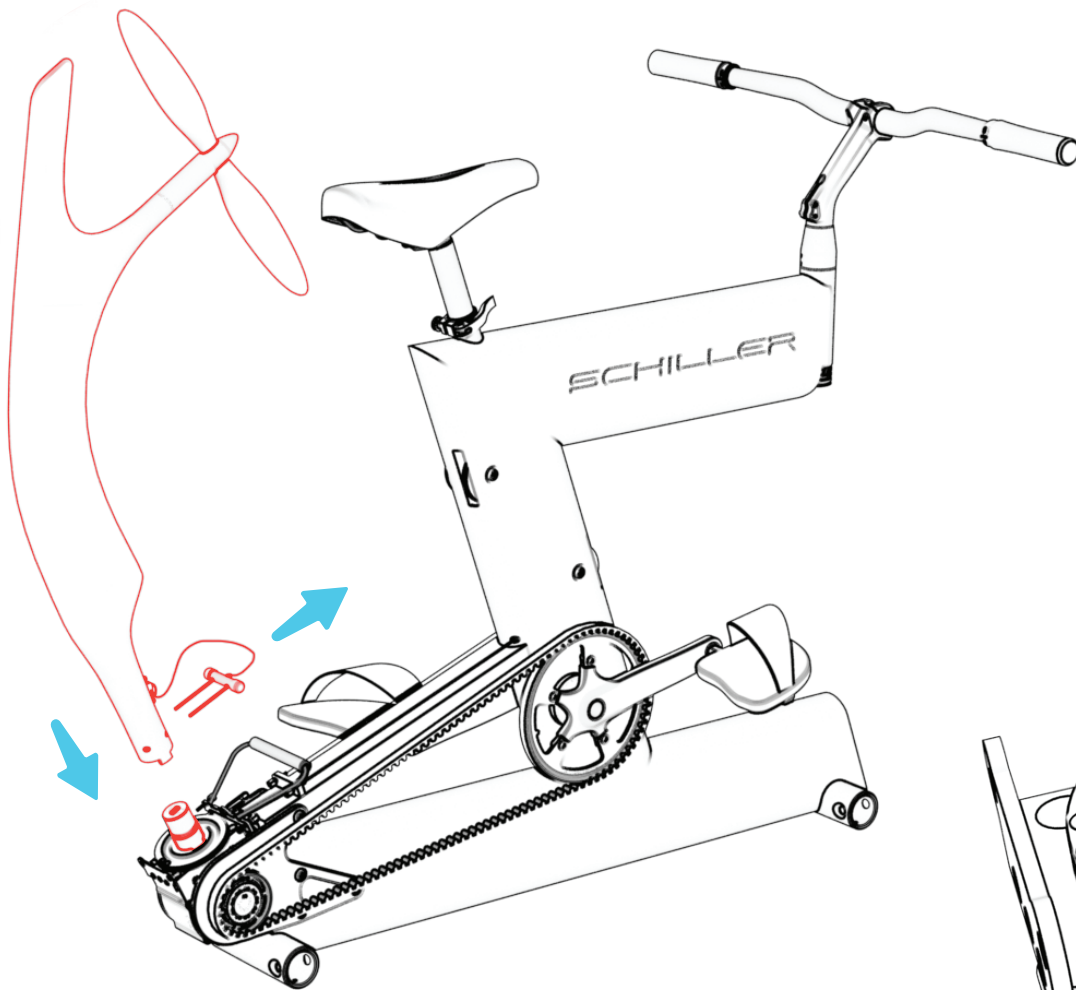

2

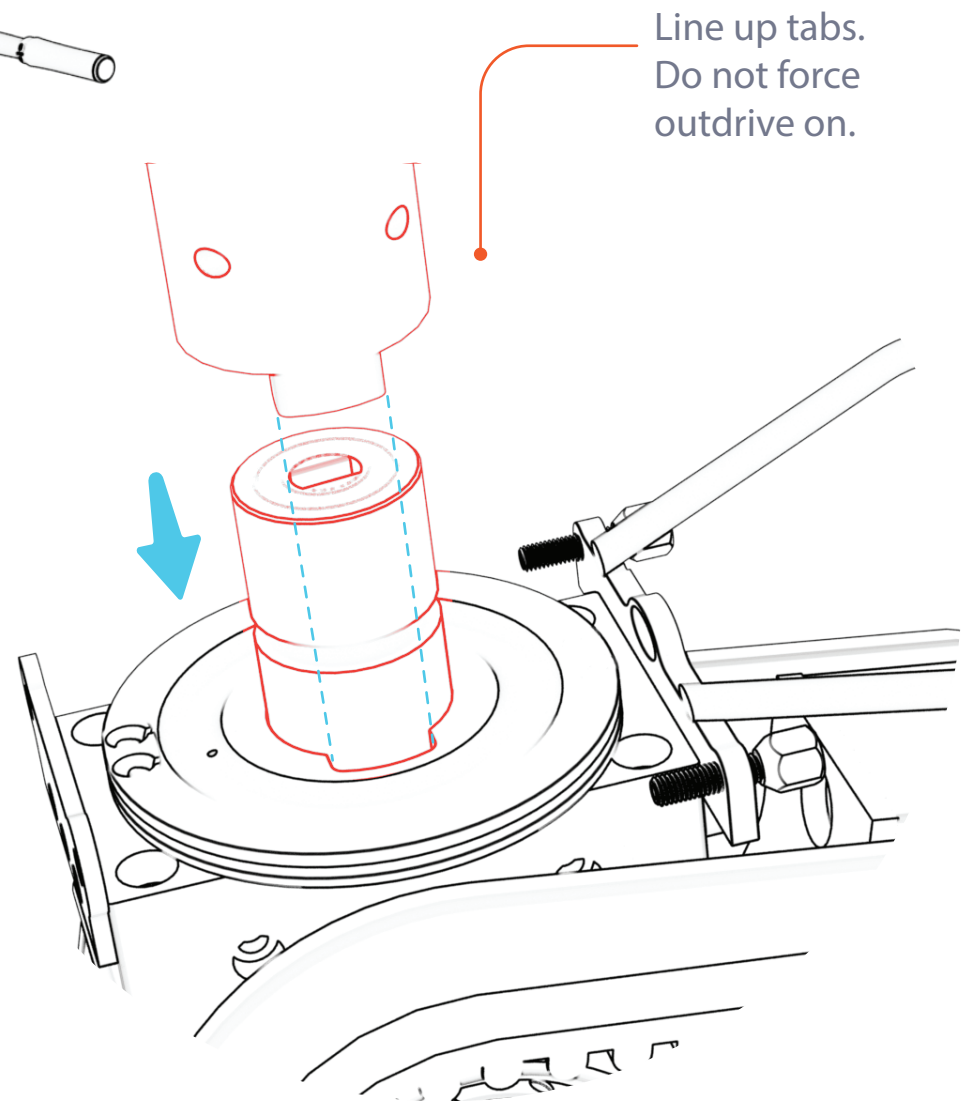

3

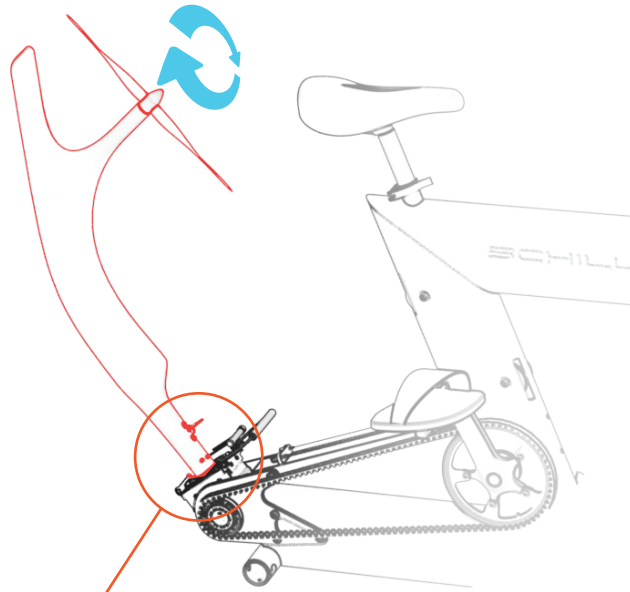

Twist Prop to fully
engage Outdrive.

The outdrive will drop into slot
when succesfully engaged.

4

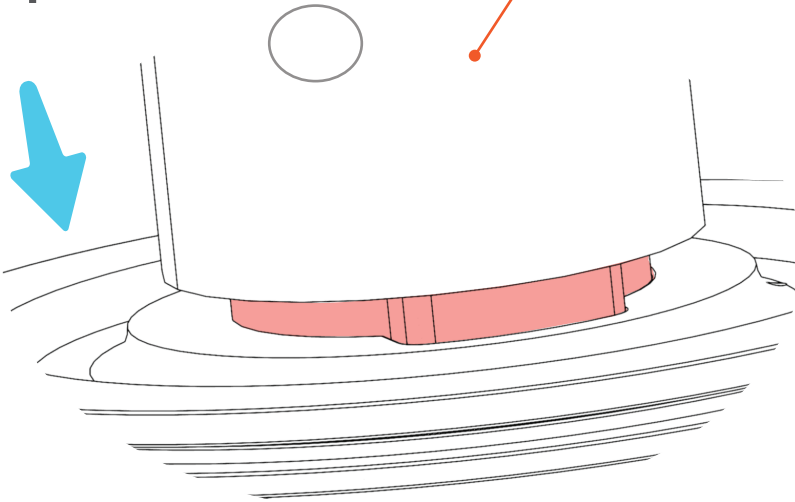

5

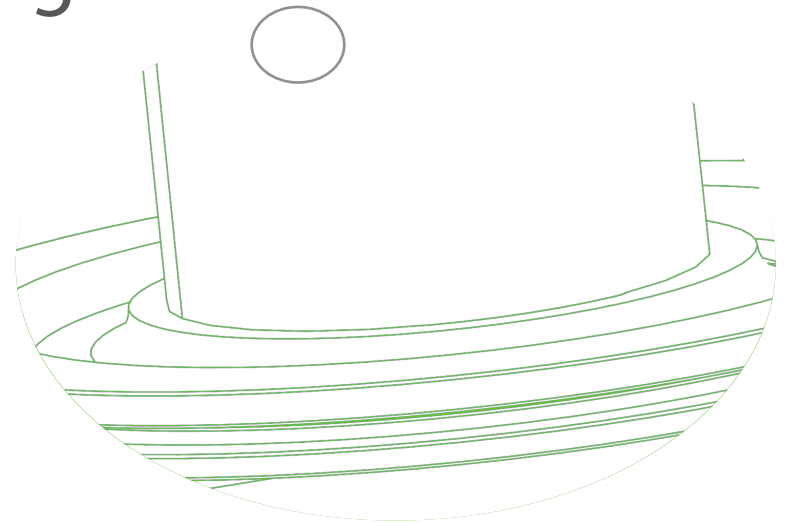

6

Insert Outdrive
Lock pin

7

Clip tether cord to gearbox

8

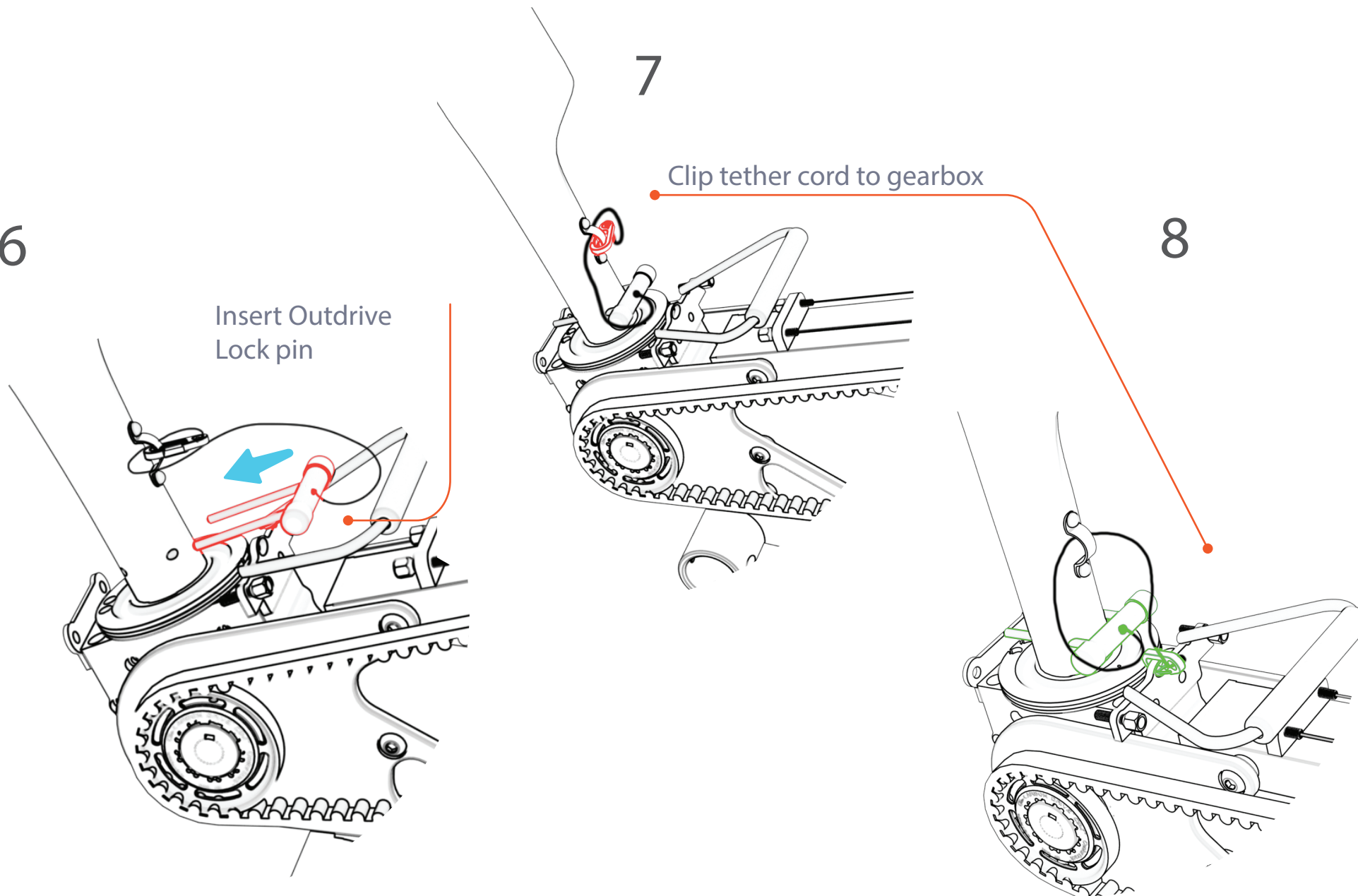

Longer end inserts into
bike frame sockets.

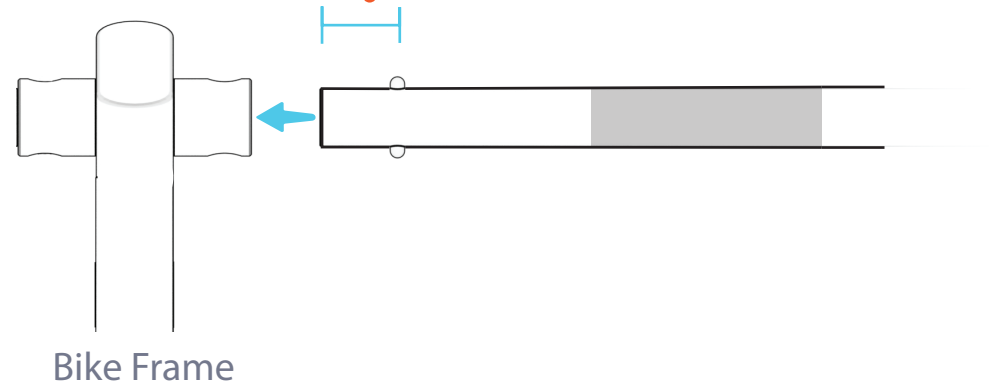

Insert struts
before inflating
pontoons.

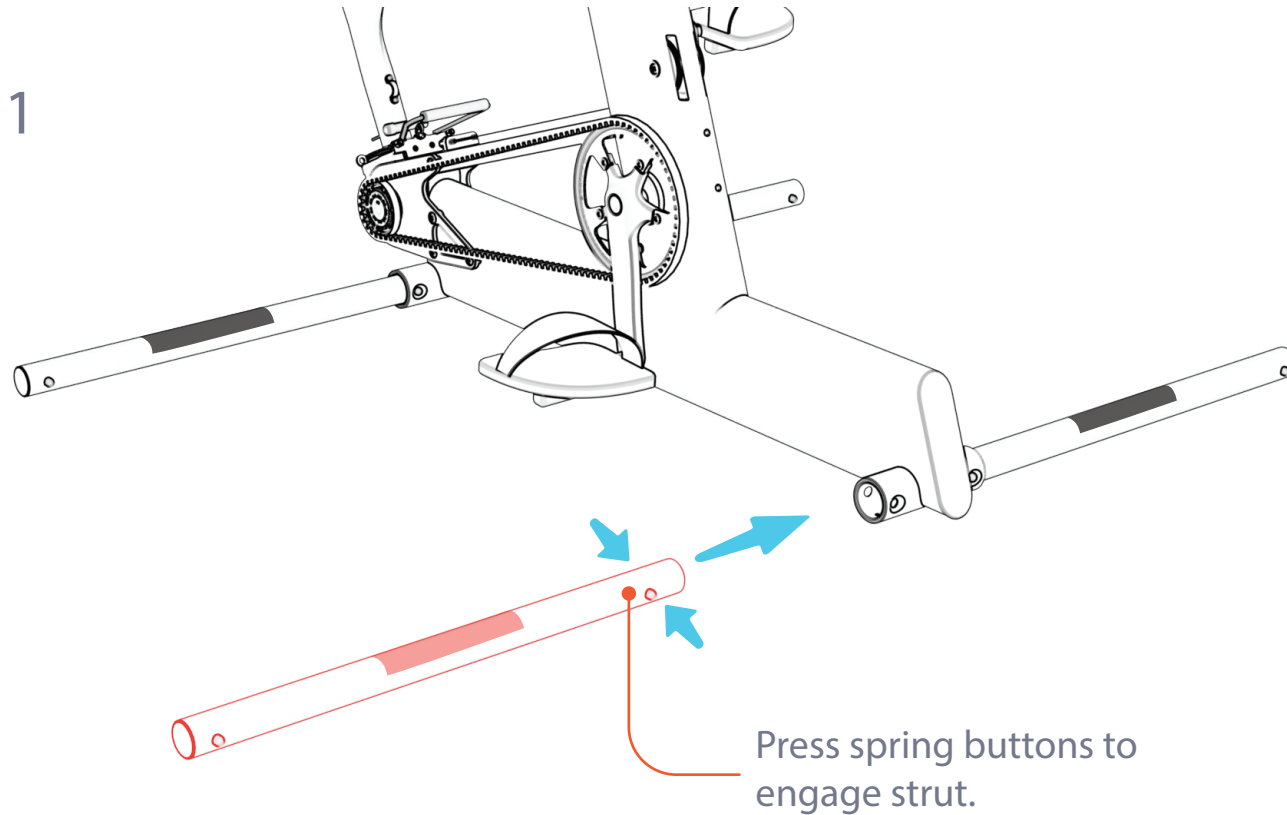

2

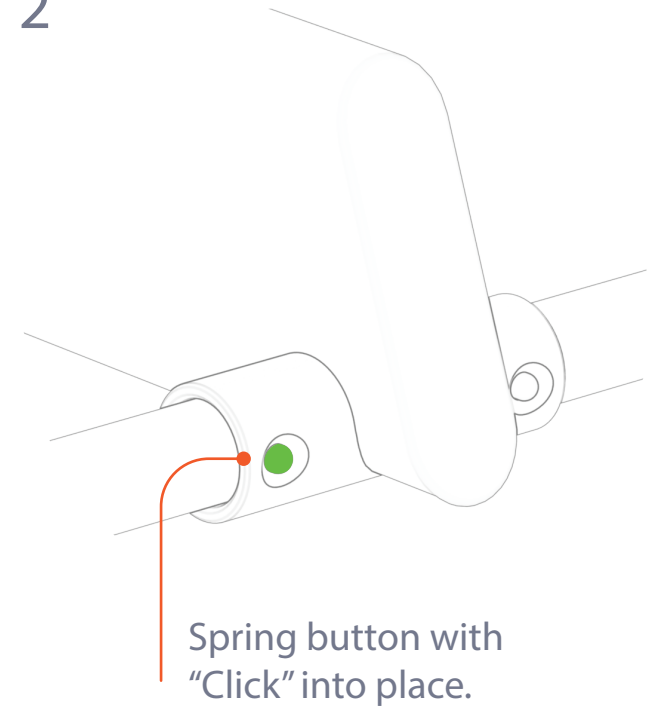

Shorter end inserts into
pontoon sockets.

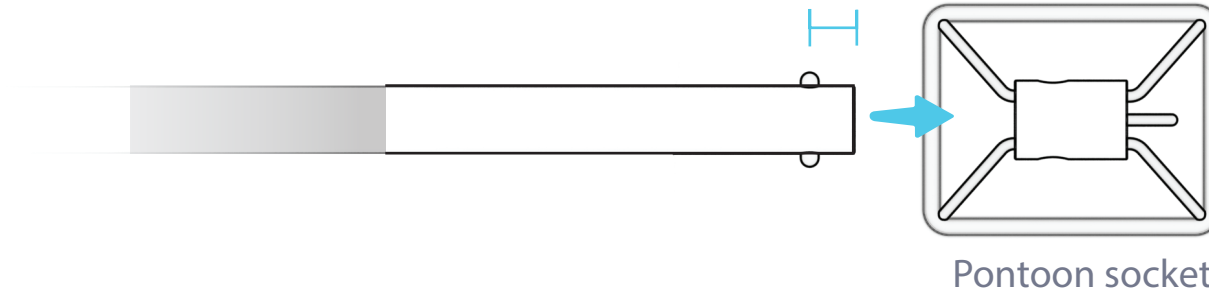

1

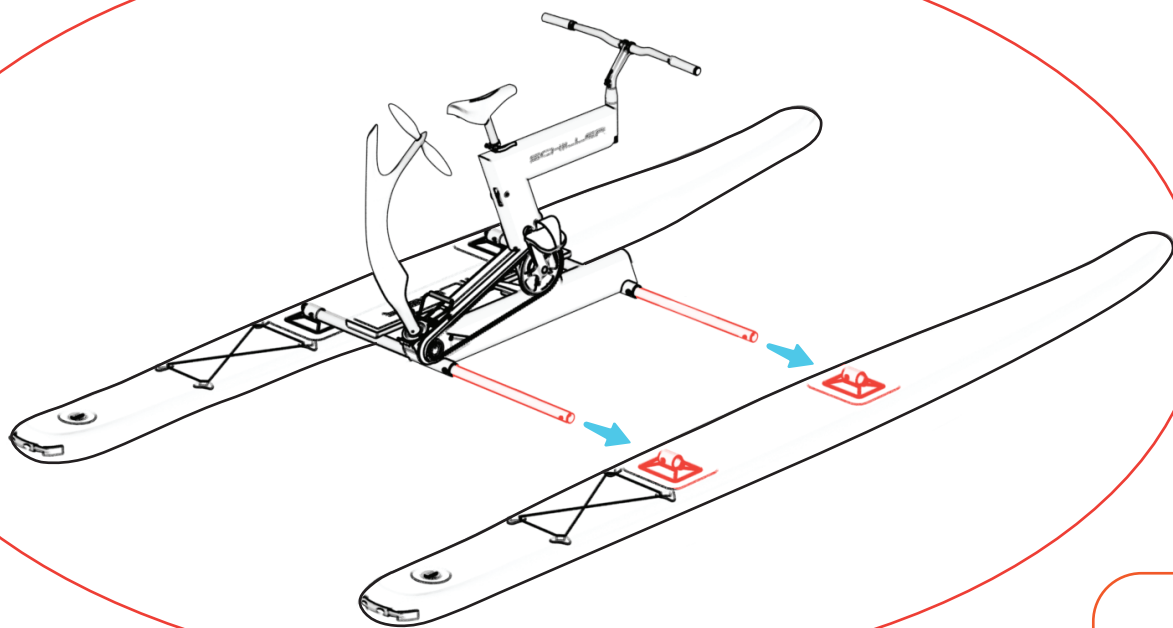

2

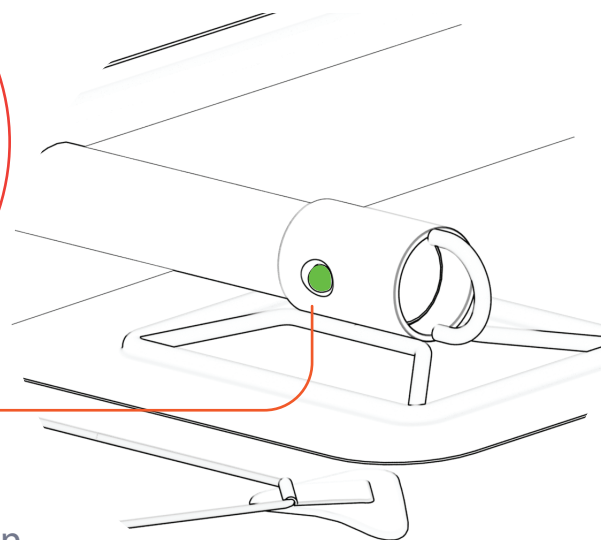

Spring button
with "Click" into
place.

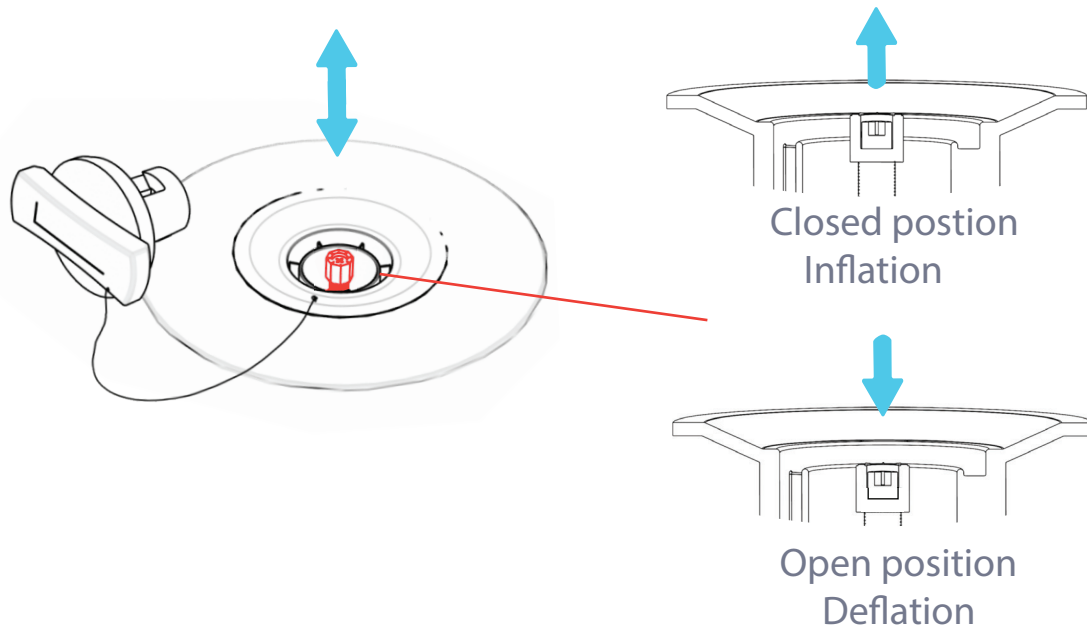

Inflate pontoon
to 10 PSI

Replace cap after
pontoon is inflated.

4

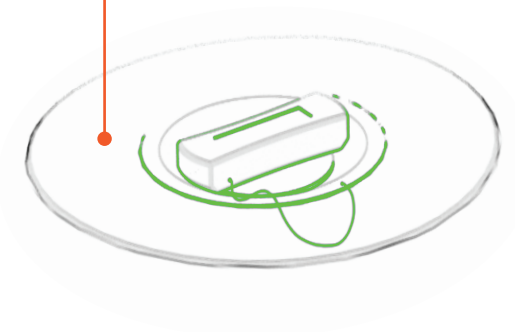

2

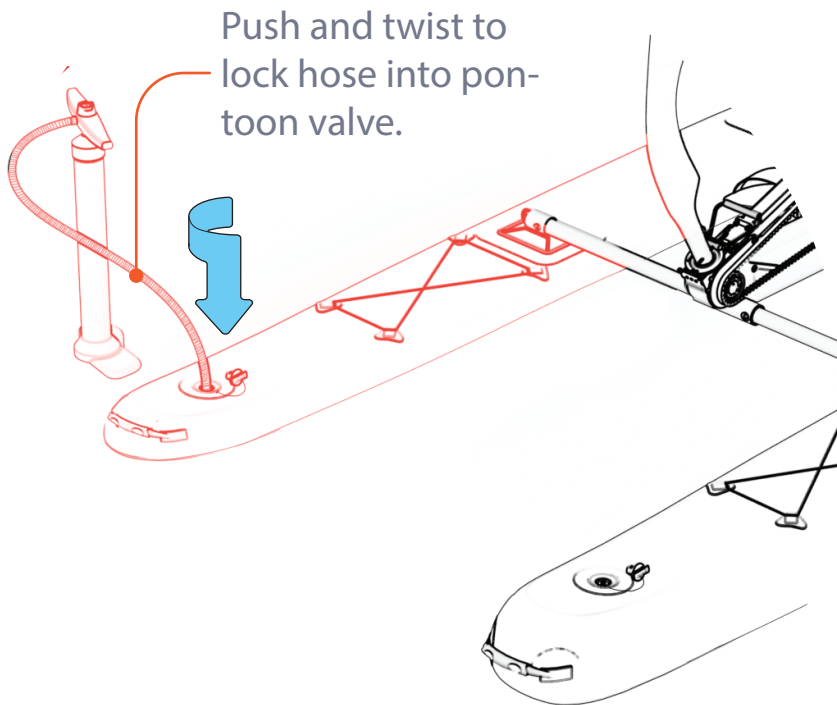

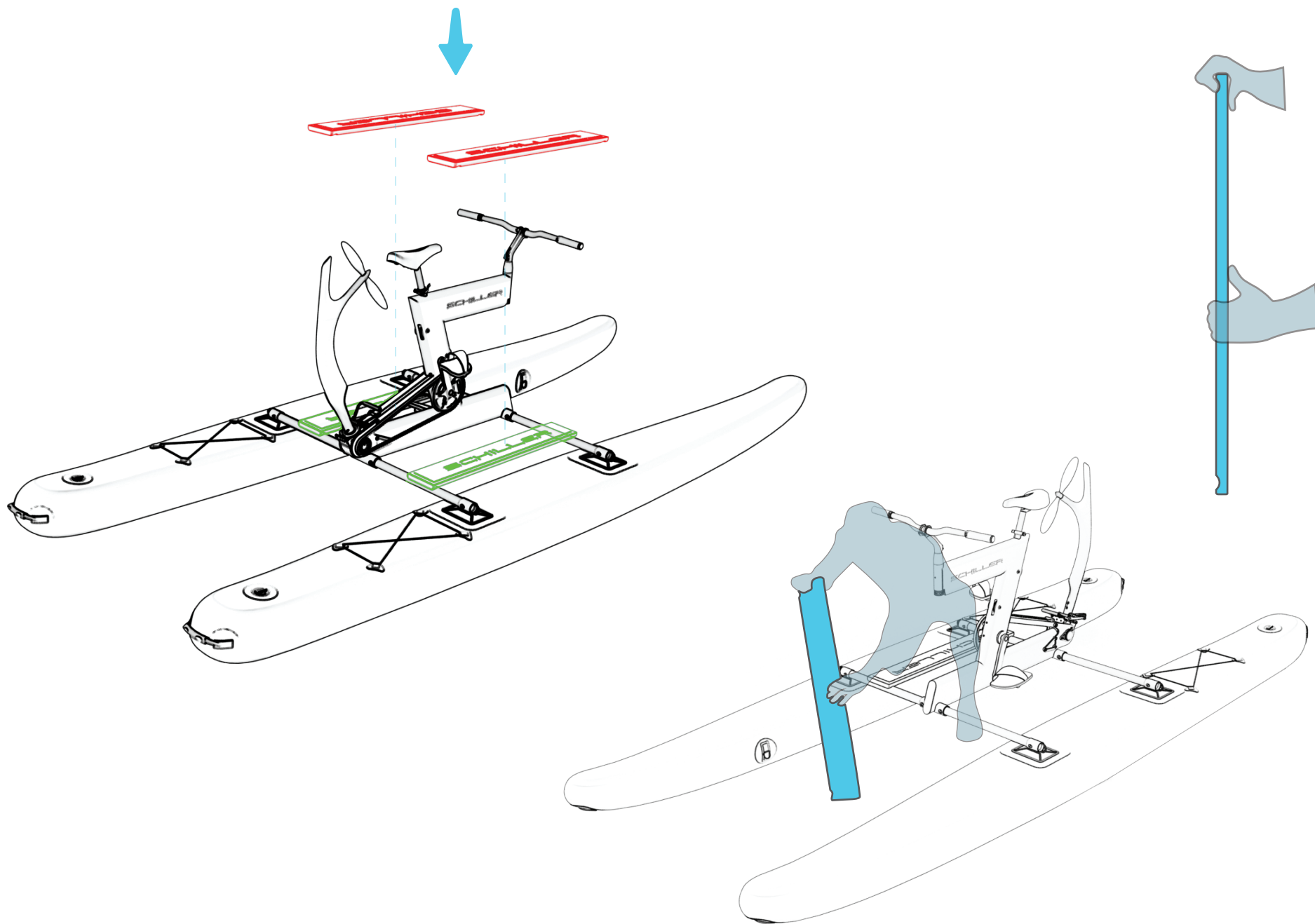

A running board can be used as a paddle.

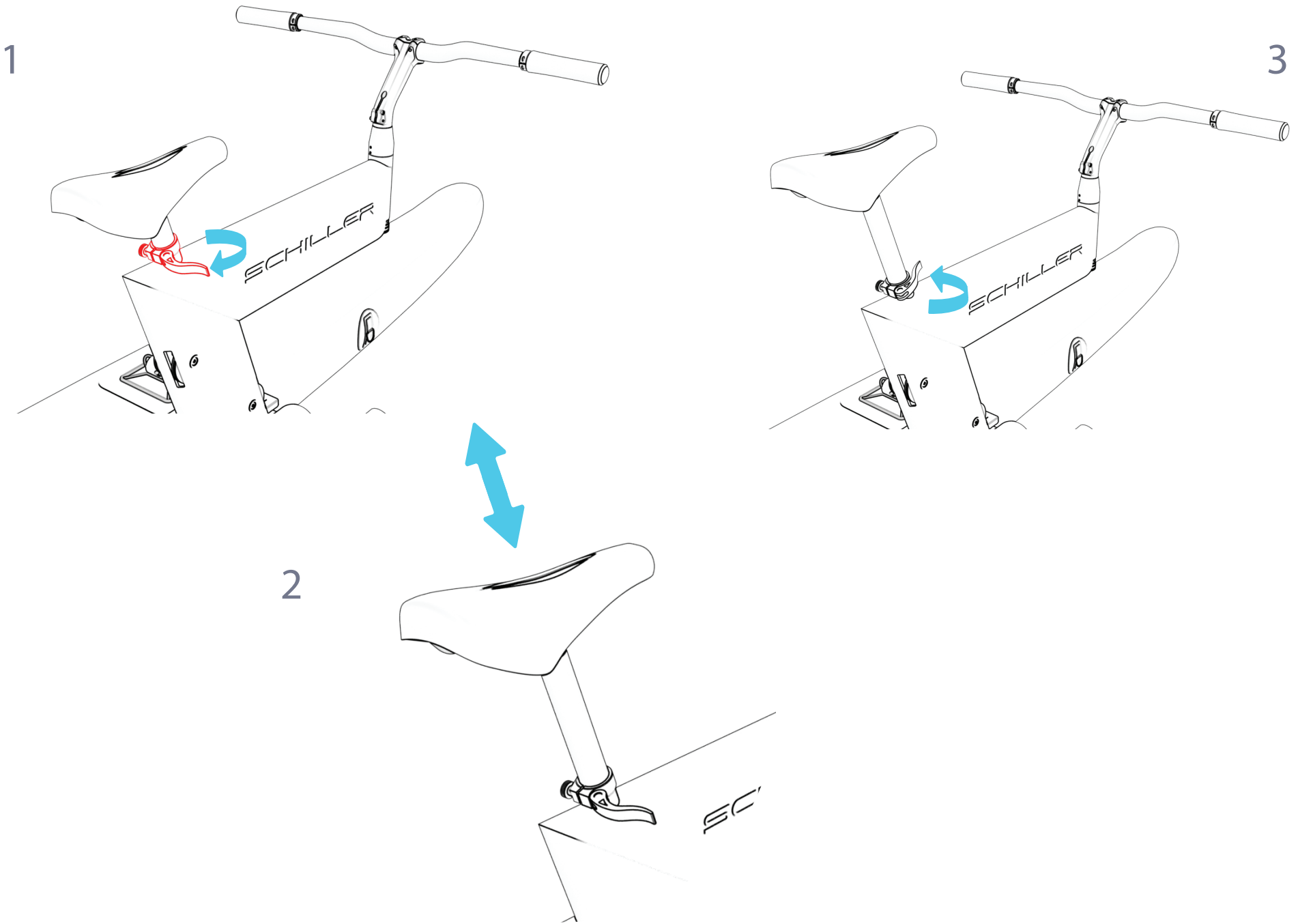

Adjust the resistance of the pivot function
on the outdrive.

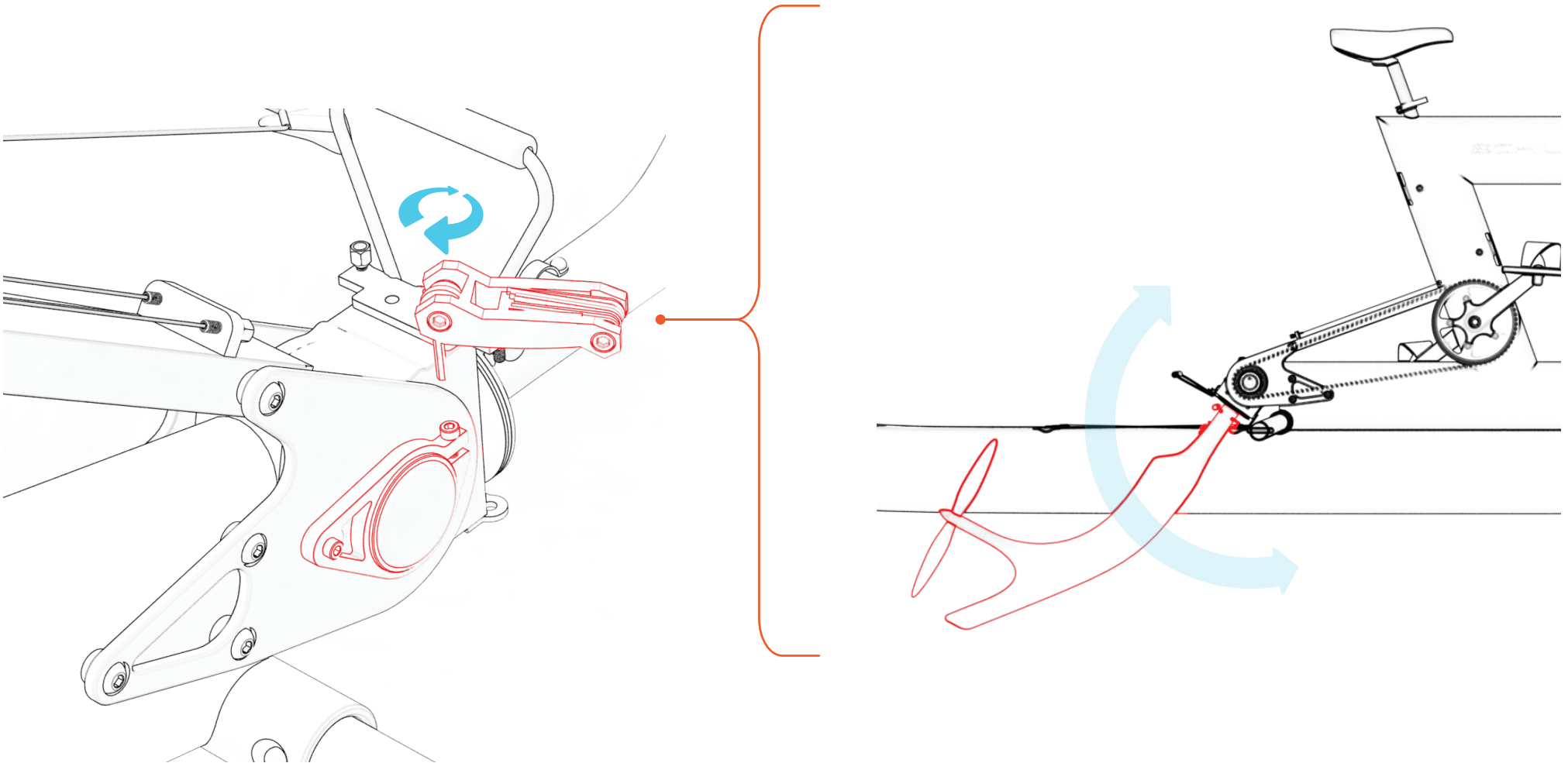

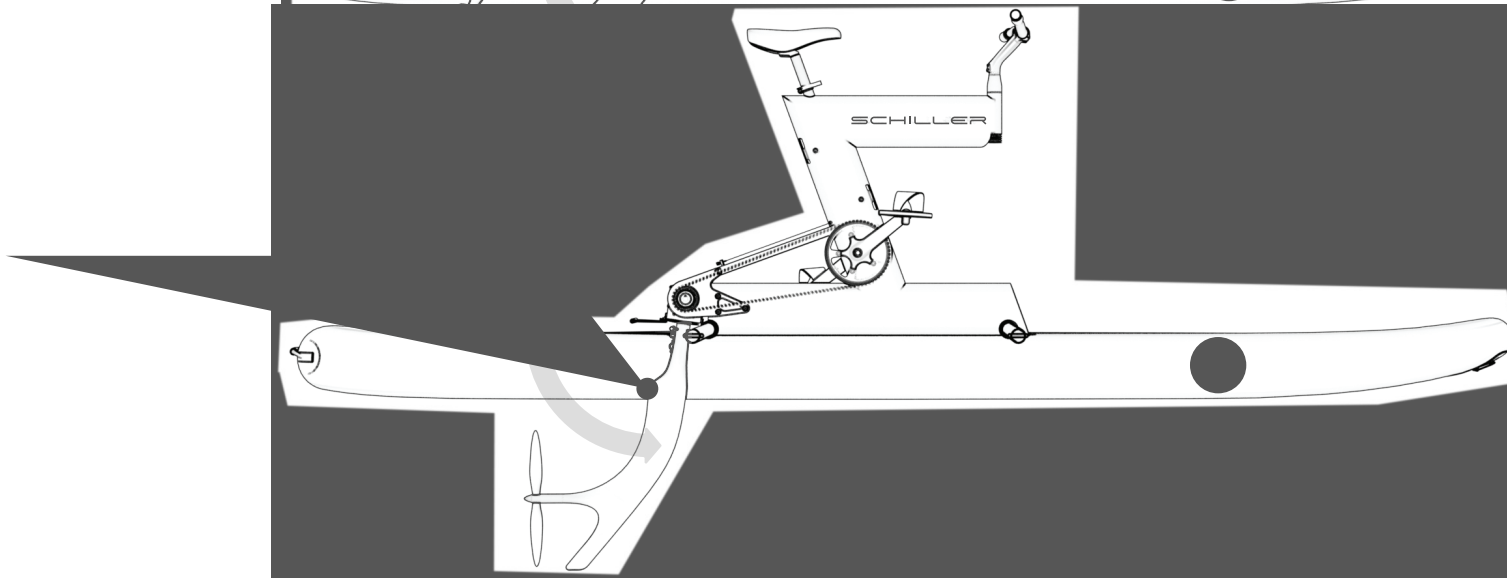
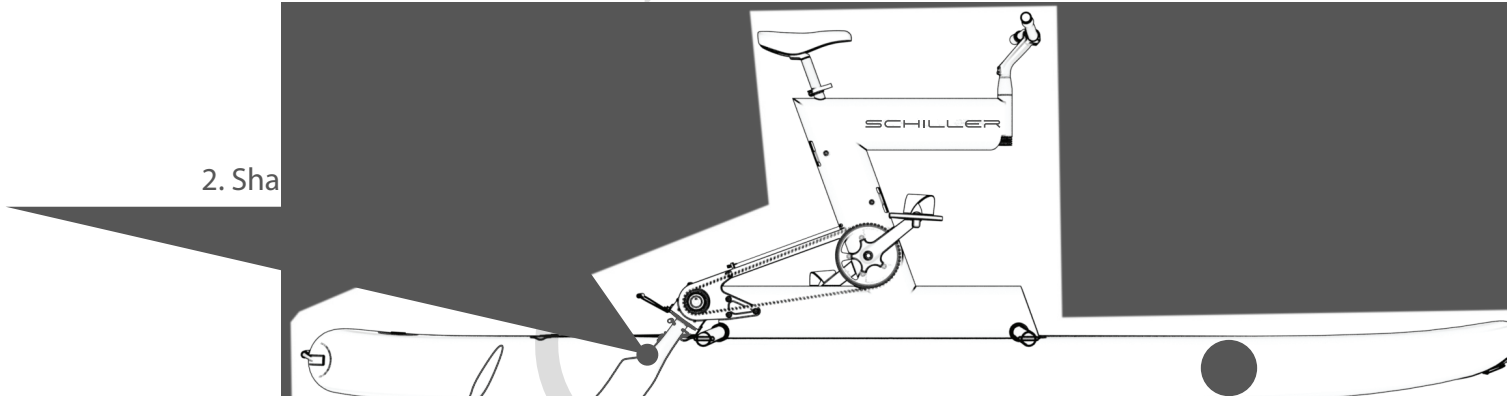
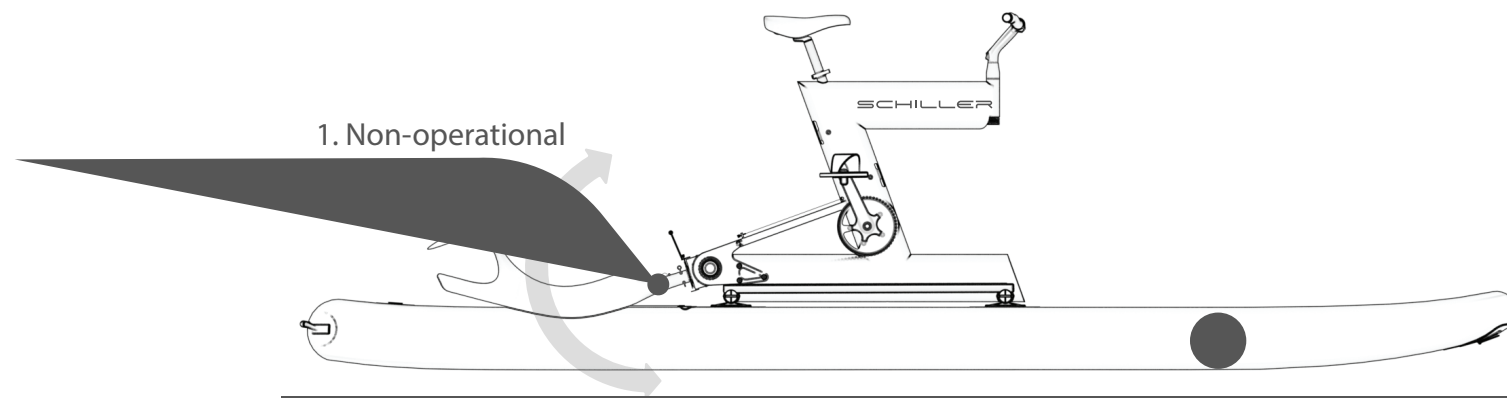

General Guidelines

The S1 was designed to enjoy smooth waterways such as harbors, inlets, bays and lakes with no previous maritime experience. As with any small marine craft, safety should be your number one priority.

You should always wear a coast guard approved personal flotation device (PFD) and ride in conditions that you are confident and comfortable in. It is not recommended to ride your S1 in surf conditions, or river rapids of any category – this will void your manufacturer's warranty.

Please thoroughly read this manual and familiarize yourself with your S1 prior to biking, especially in open water. By using this product you acknowledge and assume the inherent risks involved with any physical water sport.

Always

- Wear a coast guard approved PFD
- Tell a friend of your water biking trip and expected return time
- Carry a communication device like a phone or VHF radio
- Plan for the expected conditions by dressing appropriately
- Know your limits - especially when navigating unfamiliar waterways. Check your equipment prior to launch for signs of wear & tear or damage
- Ensure your pontoon valves are closed & your valve cap is on
- Be wary of rocks, sharp objects & floating debris that can damage your bike's pontoons
- Be cognizant of other vessels - especially the wakes of larger vessels
- Maneuver your bike to take other vessel wakes or swells head on

Never

- Overload your bike with more than one rider - this will void your manufacturer's warranty
- Bike alone without telling a friend of your trip plan
- Bike at night without coast guard compliant navigational lighting
- Bike in rapids, breaking surf, white water or flooded waterways – this will void your manufacturer's warranty
- Bike under the influence of drugs or alcohol
- Allow large swells or vessel wakes to hit your bike side on – this could capsize your bike
- Drag your pontoons and Outdrive over asphalt or any other rough surface that will damage them

Steering

The best way to steer your S1 is slowly and gently from the handle bars. Do not quickly torque the handlebars back and forth. This excessively stresses the entire steering system. It may cause the steering cables to snap.

Stopping & Reversing

To stop your S1, stop pedaling or gently pedal in reverse.

Beaching

To beach your S1, simply approach the beach **HEAD ON** at a normal speed. Stop pedaling and let the pontoons slide onto the sand. Be cautious of sharp sea shells, rocks, and glass they can puncture the pontoons. The Outdrive will automatically pivot up when it contacts the bottom. Get off the bike and **IMMEDIATELY** raise the Outdrive. Do not drag the pontoons on the beach. If you must drag the S1 make sure the sand is clear of sharp objects.

Approach waves, and boat wakes head on

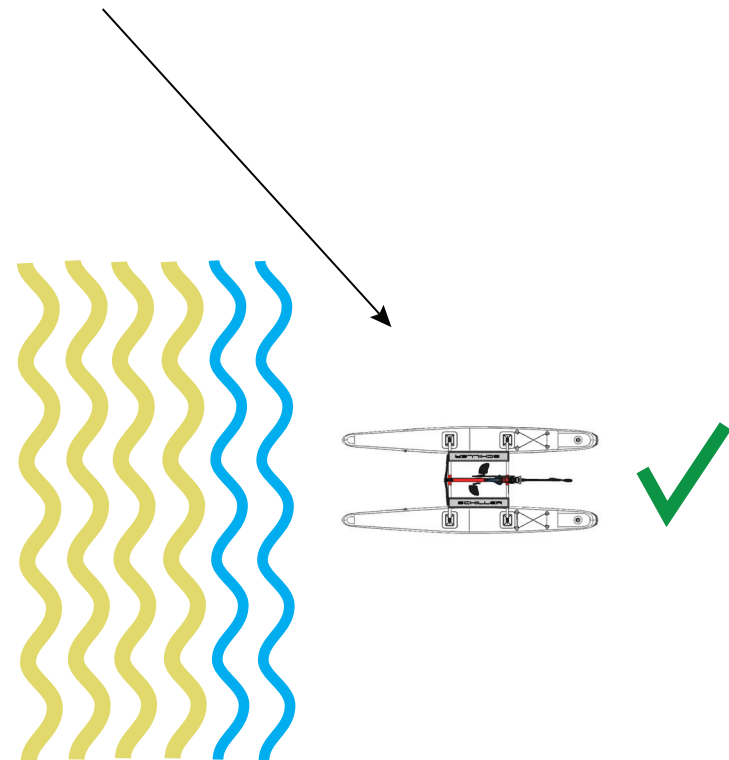
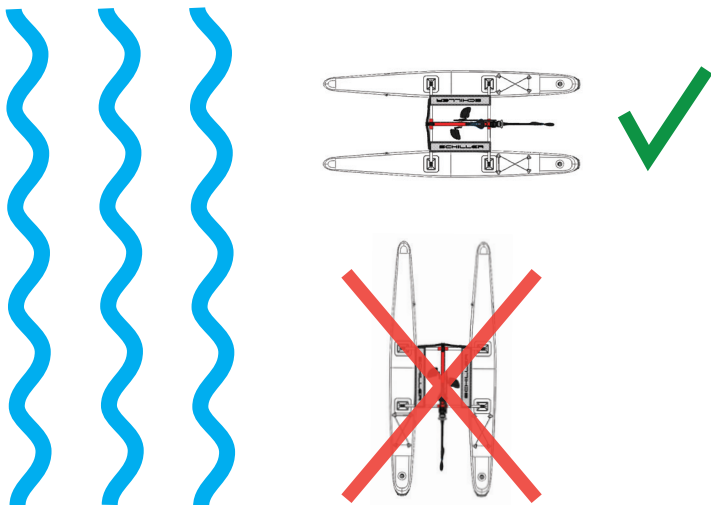

Do not attempt to launch in rough surf conditions.

Maintenance & Care

Your S1 is engineered with premium stainless steel and anodized aluminum components. It should be stored out of adverse weather conditions, extreme temperatures, and prolonged sunlight.

Like any water craft, it is important that you care for your S1 with regular maintenance. We recommend always rinsing off your S1 with fresh water after use.

The Gates Carbon Belt does not require lubrication. Your drive train should only be cleaned with fresh water.

Steering cables will stretch, this is normal. Tensioning will be necessary after the first few rides. Tension can be checked by squeezing the two cables together. If you can easily pinch the cables together and touch, tension is too low. Located on the rear of the frame, and on the back of the gearbox are cable tension adjuster screws. They can be rotated counter clockwise by hand, or with a 9mm wrench to increase tension. Tighten one side, then the other equally, unless you are trying to slightly adjust the steering alignment.

Replace your steering cables at least twice a year, or after 50 hrs use. Contact Schiller Support for replacement parts

The Outdrive to gearbox steering interface does require periodic lubrication. To do this remove the Outdrive, and wipe clean inside the Outdrive top fitting along with the corresponding male portion of the gearbox using a clean rag. Apply a thin layer of water proof grease only to the inside of the Outdrive top. This will ensure smooth steering when assembled. Never allow sand to get onto this interface when assembling the bike. If it ever does clean and re-grease.

Pontoon's should be rinsed with fresh water and stored out of direct sunlight. In the unlikely event a pontoon is punctured by a sharp object you can repair with a simple patch. You should never ride your bike if you suspect that your pontoons are not holding air. For your convenience the S1 ships with a puncture repair kit. Sharp objects can include beach shells, beach glass, and even barnacles.

Warranty & Support:

Warranty:

3 years on frame, 1 years on components.

Warranty does not cover:

- Inflatable pontoons (Including puncture, tear, or fading)
- Normal wear & tear
- Scratch & Dent
- Improper assembly
- Improper follow-up maintenance
- Installation of components, parts, or accesories not originally intended for or compatible with the bike as sold
- Damage or failure due to accident, misuse, abuse, or neglect
- Labor charges for part replacement or change over.

Product Support:

If you have any questions regarding your S1 please contact the Schiller team at info@schillerbikes.com and we will be happy to assist.